

NOTE
1 EXISTING 8" P.V.C. SANITARY SEWER AND EXISTING 6" P.V.C. WATER MAIN PIPE TO BE REMOVED/ABANDONED AFTER NEW WATER AND SEWER MAINS BEEN CONSTRUCTED AND CERTIFIED. CONSTRUCTOR SHALL VERIFY LOCATION OF EXISTING SERVICES PRIOR TO START OF DEMOLITION. CONTRACTOR SHALL MAINTAIN UNINTERRUPTED SERVICES DURING CONSTRUCTION AND COORDINATE WITH UTILITY PROVIDER WHEN WORK IS CONDUCTED IN AREAS OF SERVICES TO REMAIN.

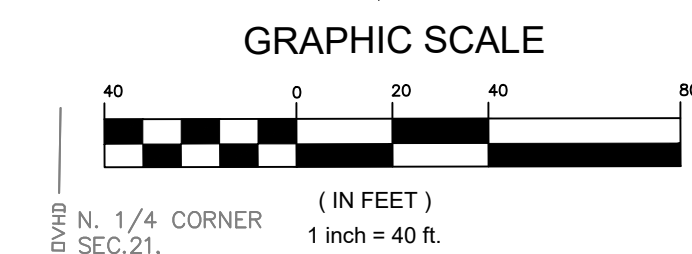

HATCH LEGEND

- NOTES**
- ALL CONSTRUCTION WORK AND MATERIALS SHALL BE IN ACCORDANCE WITH BROWARD COUNTY WATER AND WASTEWATER SERVICES (BCWWS) STANDARDS AND SPECIFICATIONS.
 - ALL EXISTING MAINS BEING IMPACTED BY THIS PROJECT AND ALL PROPOSED WATER AND SEWER FORCE MAINS AND FITTINGS, TO BE RESTRAINED PER GS 2.0
 - 2.5 DEGREE MAXIMUM DEFLECTION, TYPICAL.
 - CONTRACTOR TO VERIFY LOCATION AND INVERT ELEVATION OF EXISTING WATER, FORCE MAIN AND ALL EXISTING UTILITIES PRIOR TO COMMENCEMENT OF WORK.
 - ALL REMOVED FIRE HYDRANTS MUST BE RETURNED TO BCWWS.

NOTE
ELEVATIONS AS SHOWN WERE CONVERTED FROM THE NATIONAL GEOGETIC VERTICAL DATUM OF 1929 (NGVD 29) TO THE NORTH AMERICAN VERTICAL DATUM (NAVD 88) USING THE FOLLOWING CONVERSION: NGVD 29 VERTICAL DATUM (IN FEET) - 1.56' = NAVD 88 VERTICAL DATUM. THE CONVERSION FACTOR WAS OBTAINED FROM THE NATIONAL GEODETIC SURVEY WEBSITE ORTHOMETRIC HEIGHT CONVERSION PROGRAM USING THE LATITUDE AND LONGITUDE OF THE PROJECT LOCATION TO DETERMINE A CONVERSION FACTOR FOR THIS SPECIFIC LOCATION.

NOTE
THE MINIMUM COVER DEPTHS REQUIRED FOR PVC AND DIP SEWER MAINS ARE RESPECTIVELY 36 AND 30 INCHES.